

ИП ЯРУНИЧЕВ Е.В.

231310, Беларусь, Лидский р-он,
д.Винковцы, д.46а

Telephone: +375 29 6645977, +375 29
2883297

Fax:

Email: dieselservis@yandex.ru

Sales tax registration no.:

Timing Belt - Installation

Timing Belt - Installation

1. Temporarily fit crankshaft pulley.
2. Ensure crankshaft pulley timing marks aligned [2] .
3. Remove crankshaft pulley.
4. Install crankshaft sprocket with timing belt. Fit timing belt in anti-clockwise direction, starting at crankshaft sprocket.
5. Ensure belt is taut on non-tensioned side. Ensure lines on belt aligned with timing marks on sprockets. Arrow on belt must point away from engine.
NOTE: There should be 43 belt teeth between timing marks on sprockets [3] & [12] .
6. Slacken tensioner pulley bolt [5] . Allow tensioner to operate.
7. Temporarily fit crankshaft pulley.
8. Turn crankshaft slowly two turns in normal direction of rotation.
9. Except Almera: At approximately 90° BTDC insert 0,30 mm feeler gauge [6] between belt and guide pulley [7] . Continue to turn crankshaft until timing marks aligned [2] & [3] .
10. Hold tensioner using Allen key. Tighten tensioner pulley bolt [5] . Tightening torque: 32-40 Nm.
11. Except Almera: Turn crankshaft anti-clockwise to remove feeler gauge [6] .
12. Remove crankshaft pulley.
13. Install components in reverse order of removal.
14. Tighten crankshaft pulley bolt [8] . Tightening torque: 142-152 Nm.

Manufacturer: Nissan

Engine code: CD20

Tuned for:

Model: Primera (P10/W10) 2,0D

Output: 55 (75) 4800

Year: 1991-96

© Autodata Limited 2010

Valid forever. 30.06.2012

V8.500-ENGR598152

/Autodata

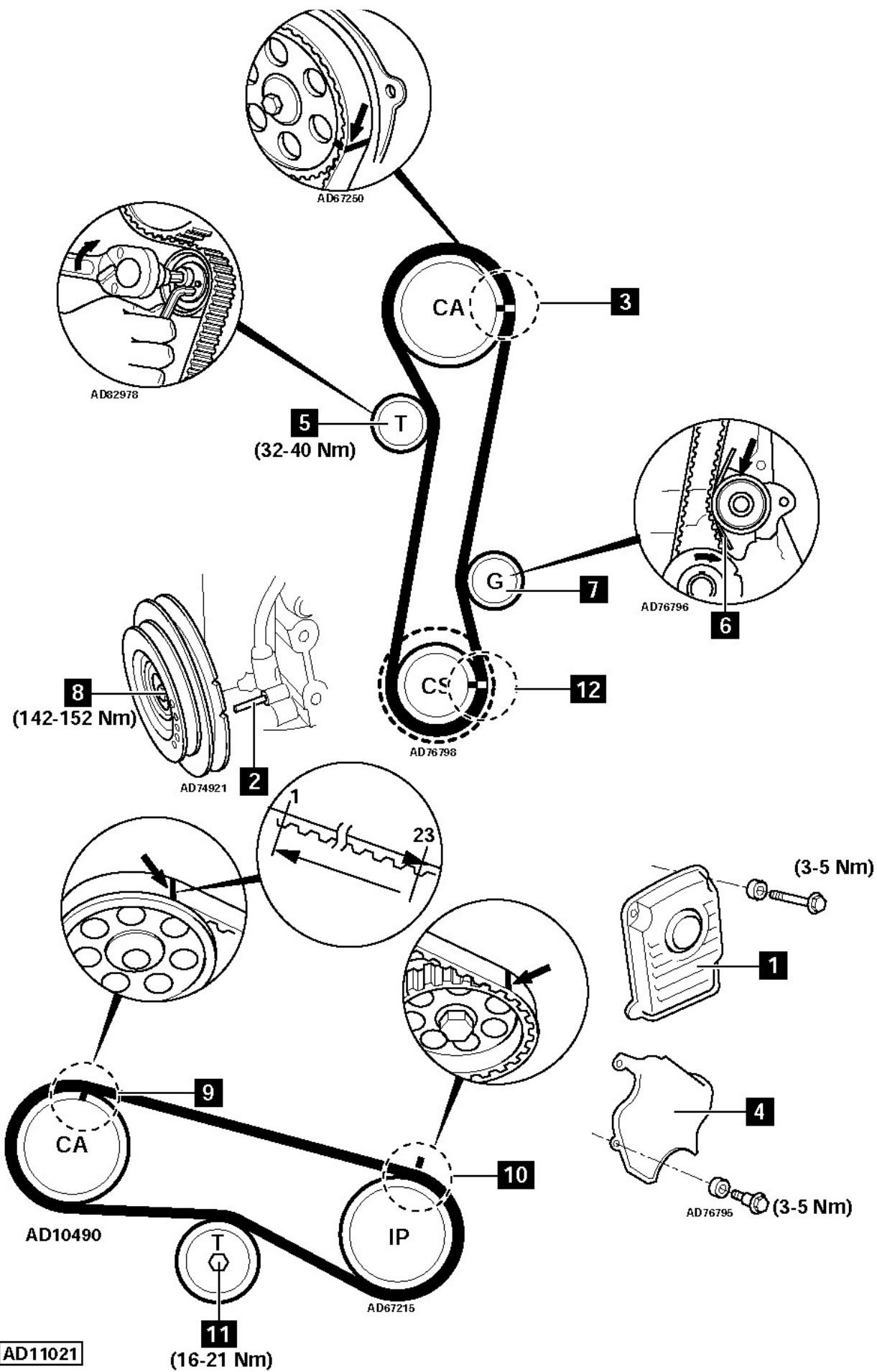

Manufacturer: Nissan
Engine code: CD20
Tuned for:

Model: Primera (P10/W10) 2,0D
Output: 55 (75) 4800
Year: 1991-96

© Autodata Limited 2010
 Valid forever. 30.06.2012
 V8.500-ENGR598152 **/Autodata**