

II. FISCAL IMPACT ANALYSIS

A. Five Year Summary of Fiscal Impact:

Fiscal Years	2018	2019	2020	2021	2022
Capital Expenditures					
Operating Costs					
External Revenues					
Program Income(County)					
In-Kind Match(County)					
NET FISCAL IMPACT	*				
#ADDITIONAL FTE					
POSITIONS (CUMULATIVE)					

Is Item Included in Current Budget? Yes No

Does this item include the use of federal funds? Yes No

Budget Account No:

Fund Agency Organization Object

B. Recommended Sources of Funds/Summary of Fiscal Impact:

* No fiscal impact

C. Departmental Fiscal Review:

III. REVIEW COMMENTS:

A. OFMB Fiscal and/or Contract Dev. and Control Comments:

Lisa Ponds 10/23/17
 OFMB

John J. Jacobson 10/24/17
 Contract Dev. & Control
 10/23/17 TA

B. Legal Sufficiency

[Signature] 10/24/17
 Assistant County Attorney

C. Other Department Review

 Department Director

(THIS SUMMARY IS NOT TO BE USED AS A BASIS FOR PAYMENT.)

**PRECINCT BOUNDARY CHANGES SUBMITTED TO
THE BOARD OF COUNTY COMMISSIONERS**

PRECINCT BOUNDARY ADJUSTMENTS – (CHANGE IN LEGAL DESCRIPTION)

3044 – 6094

(2 PRECINCTS)

NEW PRECINCT – DUE TO PRECINCT BOUNDARY ADJUSTMENTS

7175

(1 PRECINCT)

PRECINCT ELIMINATED – DUE TO PRECINCT BOUNDARY ADJUSTMENTS

3046 – 6110

(2 PRECINCTS)

Pct 3044 – 3046 (ELIMINATED)



PALM SPRINGS

Pct 6094 – 6110 (ELIMINATED)

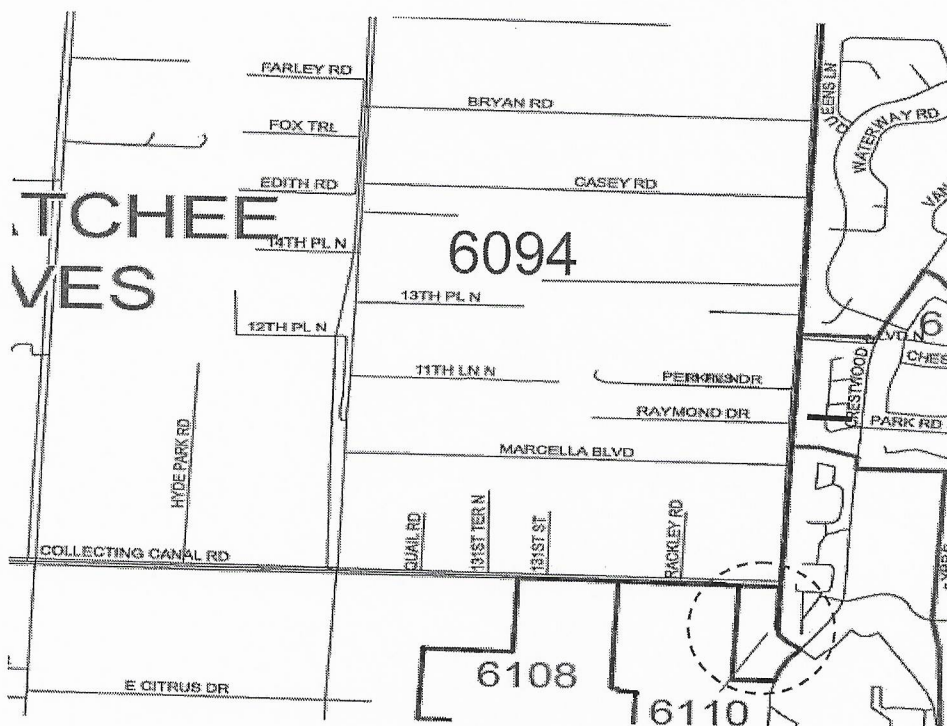

LOXAHATCHEE GROVES

Pct NP* – 7175 (NEW PRECINCT)

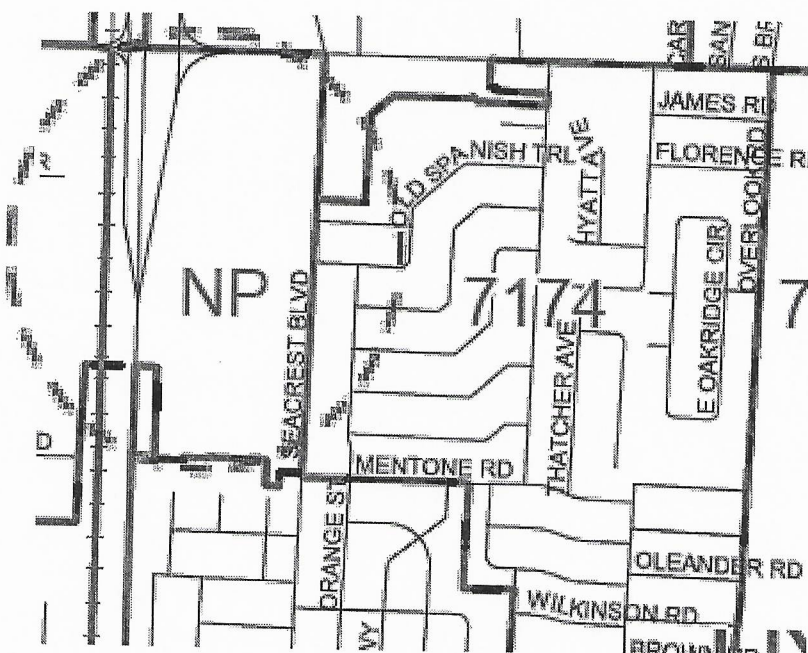

UNINCORPORATED

* No Precinct