

Safety Instructions



0,1,4,7,8,9,11,15,
17,20,22



Info Hotline

+49 (0) 5041 998 389







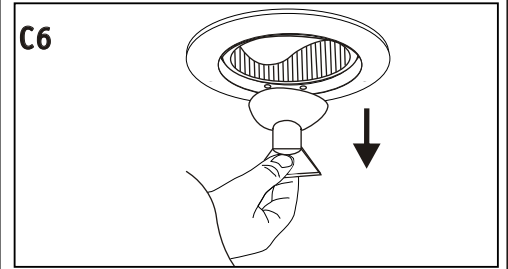
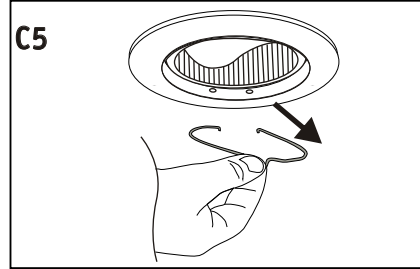
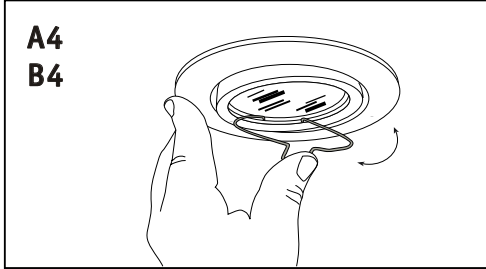
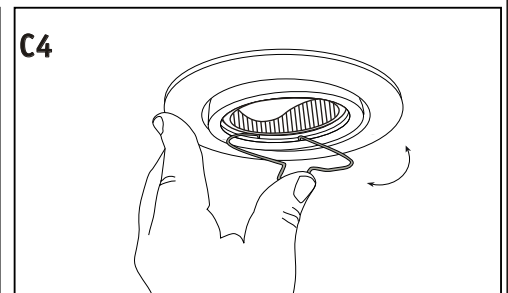
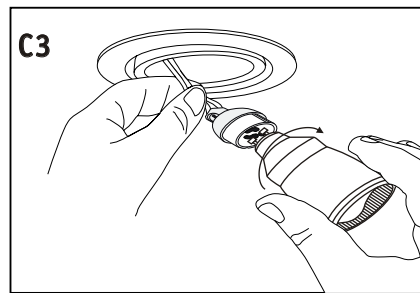
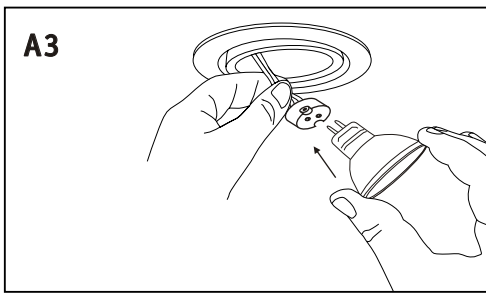
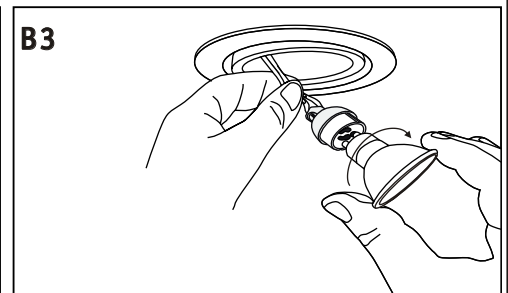
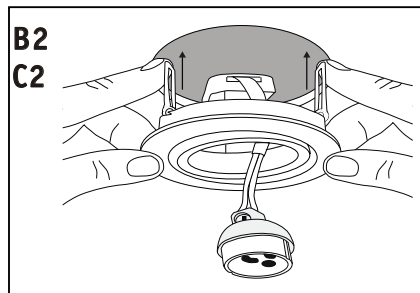
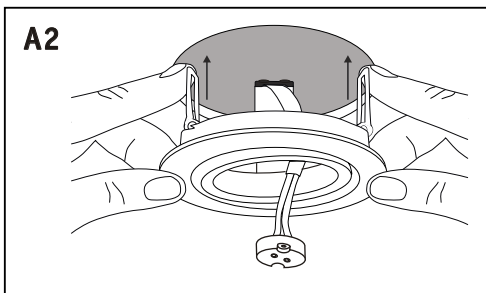
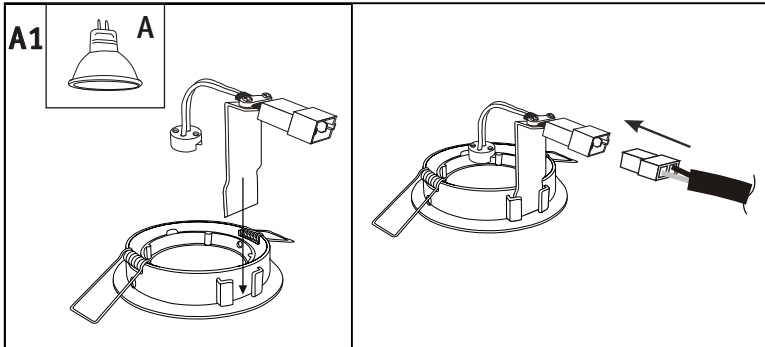
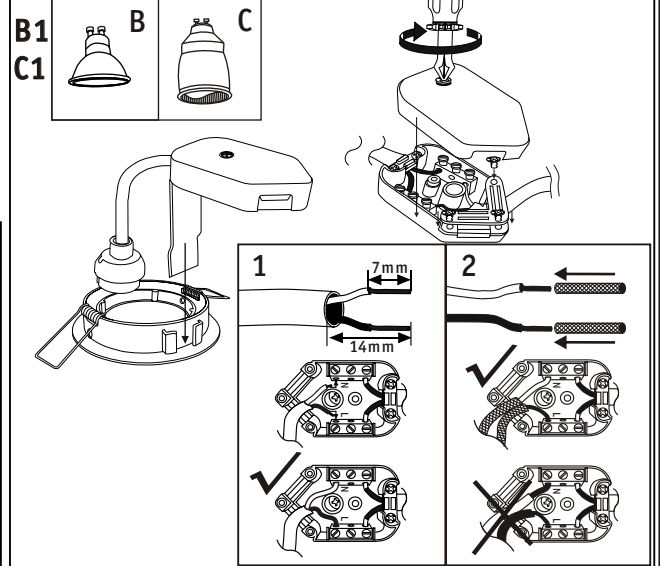
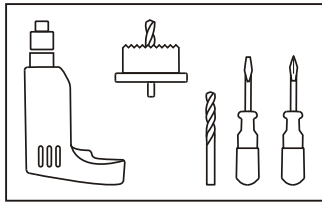

Mon. - Do. 7⁰⁰ - 20⁰⁰

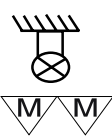
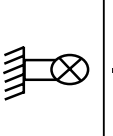
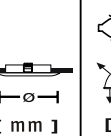
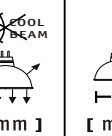
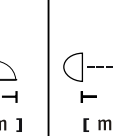
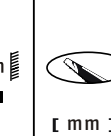
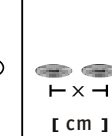
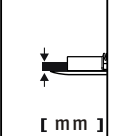
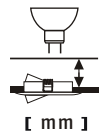
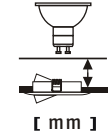
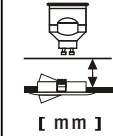
Fr. 7⁰⁰ - 17⁰⁰

Paulmann Licht GmbH
31832 Springe / Germany
www.paulmann.com

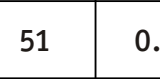
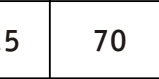
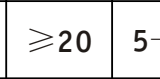
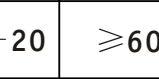
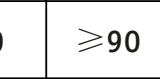
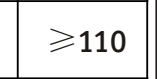
Art.-Nr.:
997. 38/
39/40/41/
42/43/44/
45/49/54/
55/56
(+MA 173)
PBO 10/09

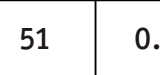
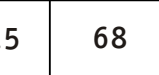
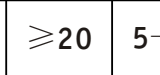
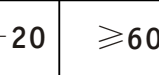
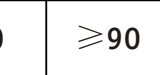
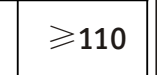

|  |  |  |  |  |  |  |  |  |  |  |
|---|---|---|---|---|--|---|---|---|---|---|
| [mm] | [mm] | [mm] | [mm] | [m] | [mm] | [cm] | [mm] | [mm] | [mm] | [mm] |
|  |  |  |  |  |  |  |  |  | | |
|  |  |  |  |  |  |  |  |  | | |