



workstories...

ASSEMBLY GUIDE

ALBION

Meeting & Breakout

Hub Tables & Seat

Info@workstories.com
020 3735 5224
workstories.com

coffee

hardware

Fixing kit provided

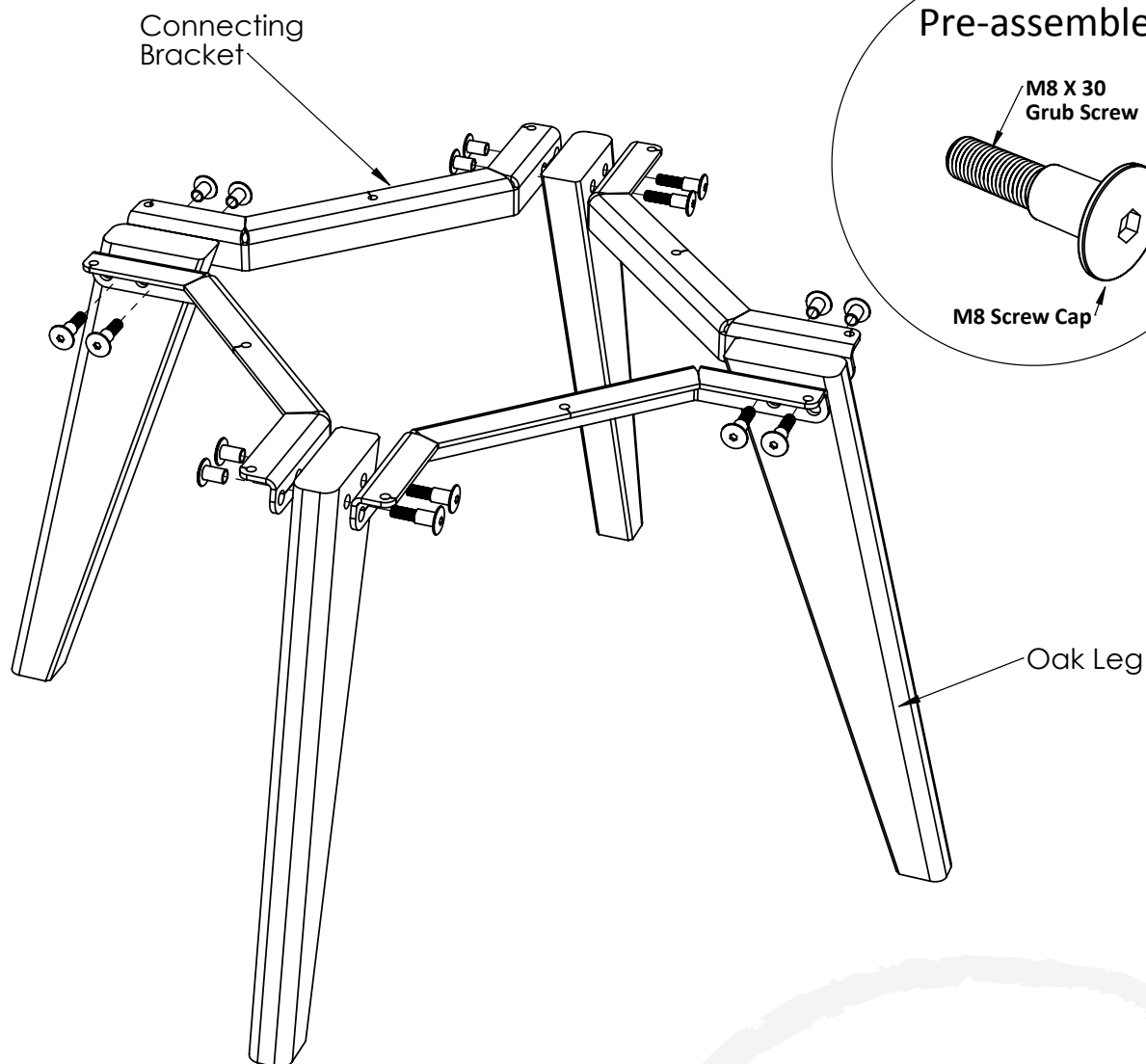
tool required4/5mm
allen key

- PRE-ASSEMBLE 8X OF THE M8 GRUB SCREWS INTO 8X OF THE M8 CAP SCREWS SUPPLIED
- PASS THE M8 GRUB SCREW / CAP SCREW ASSEMBLY THROUGH A CONNECTING BRACKET, LEG AND SECOND CONNECTING BRACKET
- SCREW ANOTHER CAP SCREW ONTO THE REAR OF THE GRUB SCREW - LEAVE LOOSE AT THIS STAGE
- REPEAT THE STEPS FOR THE OTHER LEGS
- WHEN ALL BOLTS ARE IN PLACE, TIGHTEN SEQUENTIALLY TO COMPLETE THE ASSEMBLY
- LOCATE TABLE TOP INTO POSITION AND SECURE IN PLACE THROUGH THE CONNECTING BRACKETS USING THE M6X15 CONNECTOR BOLTS SUPPLIED

meeting

hardware

Fixing kit provided

tool required

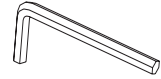

4/5mm
allen key

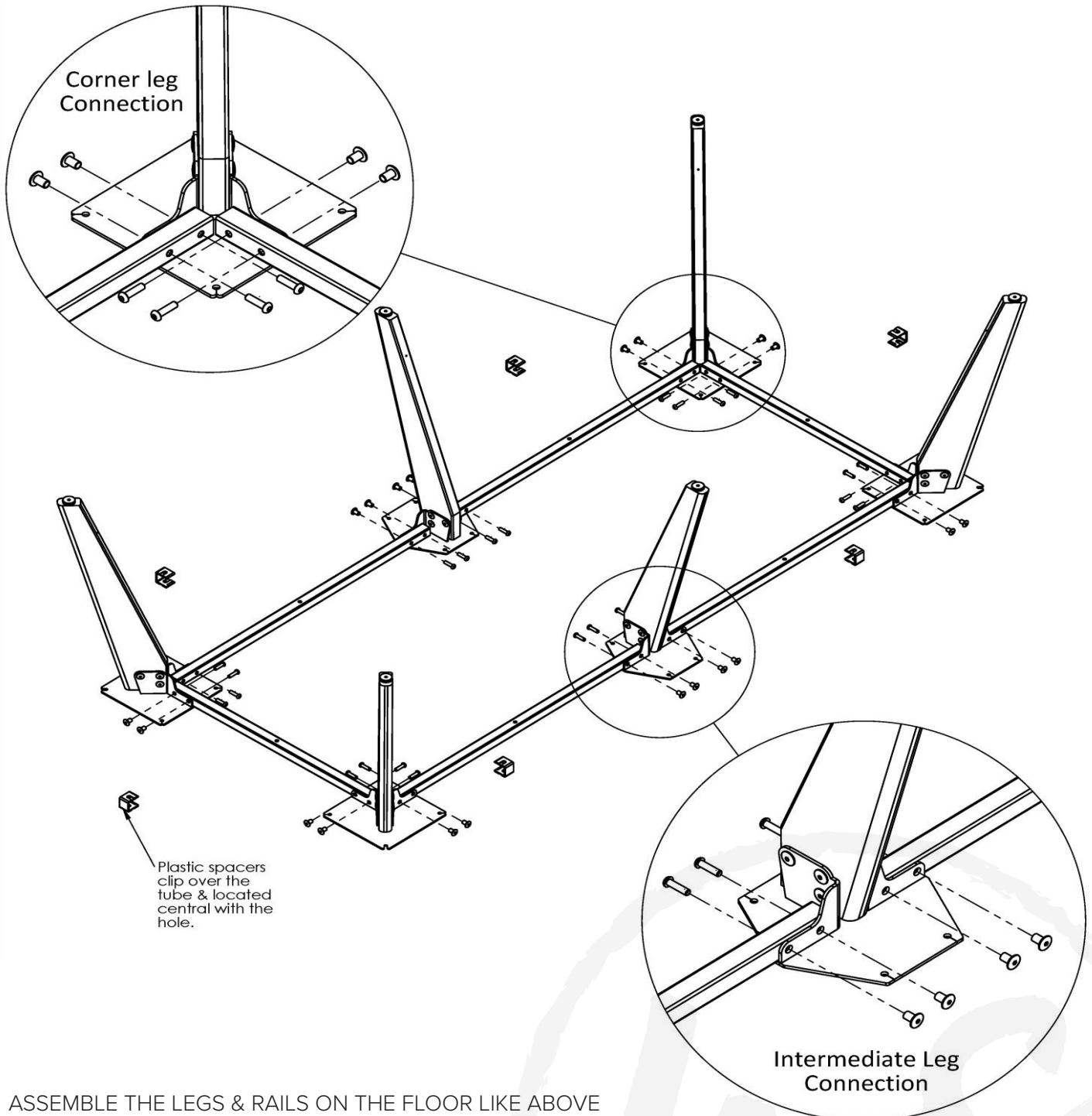

- ASSEMBLE THE LEGS & RAILS ON THE FLOOR LIKE ABOVE
- ALIGN THE RAILS AT EACH LEG CONNECTION
- PASS THE M8 CONNECTOR CAP THROUGH THE FRONT OF THE LEG BRACKET AND RAIL. INSERT THE M8 X 30 SOCKET SCREW INTO THE REAR OF THE RAIL AND TIGHTEN SEQUENTIALLY
- TURN THE FRAMEWORK OVER, LOCATE THE TABLE TOP INTO POSITION AND SECURE IN PLACE WITH M6 X 15 CONNECTOR BOLTS THROUGH THE LEG BRACKETS AND M6 X 50 CONNECTOR BOLTS THROUGH THE RAILS

hardware

Fixing kit provided

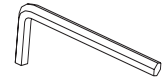
tool required4/5mm
allen key

poseur / one-piece top 800mm deep

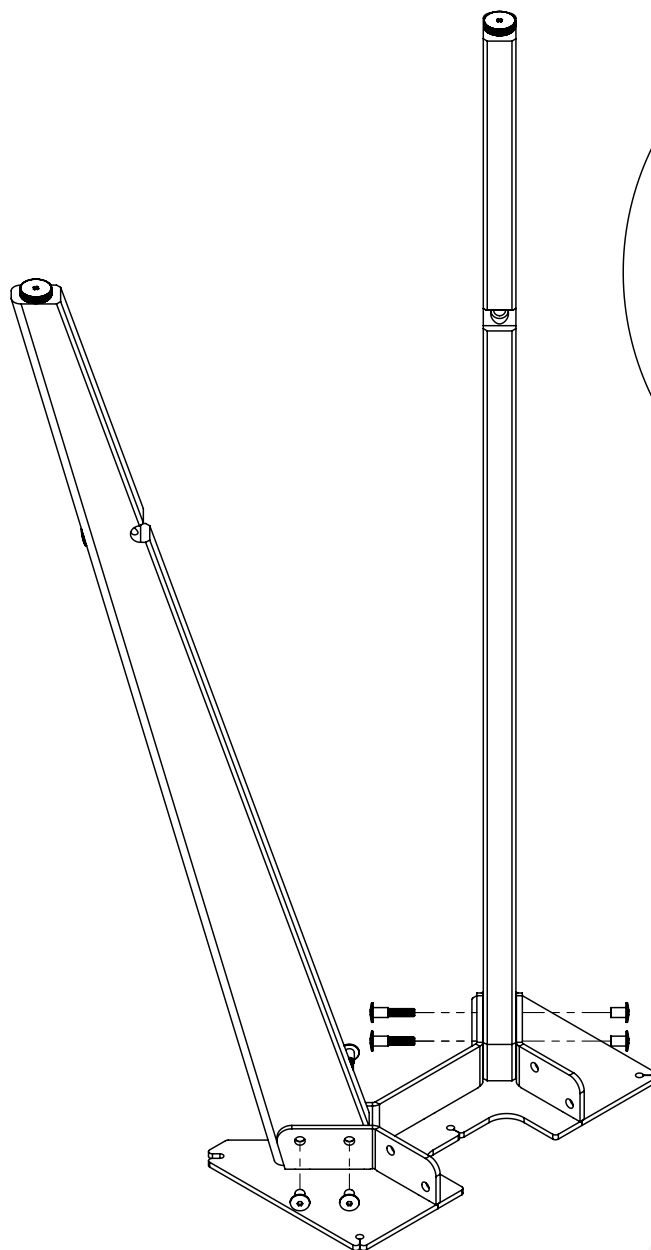
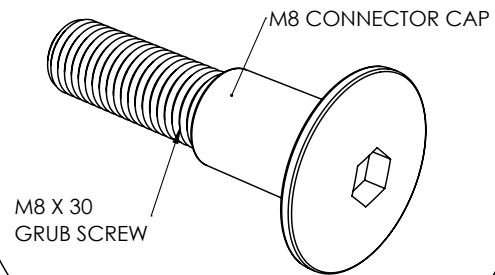
**Pre-assembly**

- PRE-ASSEMBLE THE FOUR M8 X 30MM GRUB SCREWS INTO AN M8 CAP SCREW SUPPLIED, AS ABOVE.
- PASS THE M8 GRUB SCREW/CAP SCREW ASSEMBLY THROUGH THE CONNECTING BRACKET AND LEG.
- SCREW ANOTHER CAP SCREW ONTO THE REAR OF THE GRUB SCREW - LEAVE LOOSE AT THIS STAGE.
- REPEAT FOR ALL OTHER BOLTS IN THE ASSEMBLY. WHEN ALL BOLTS ARE IN PLACE, TIGHTEN SEQUENTIALLY TO COMPLETE THE ASSEMBLY.

hardware

Fixing kit provided

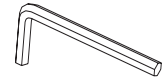
tool required4/5mm
allen key

poseur / one-piece top 800mm deep

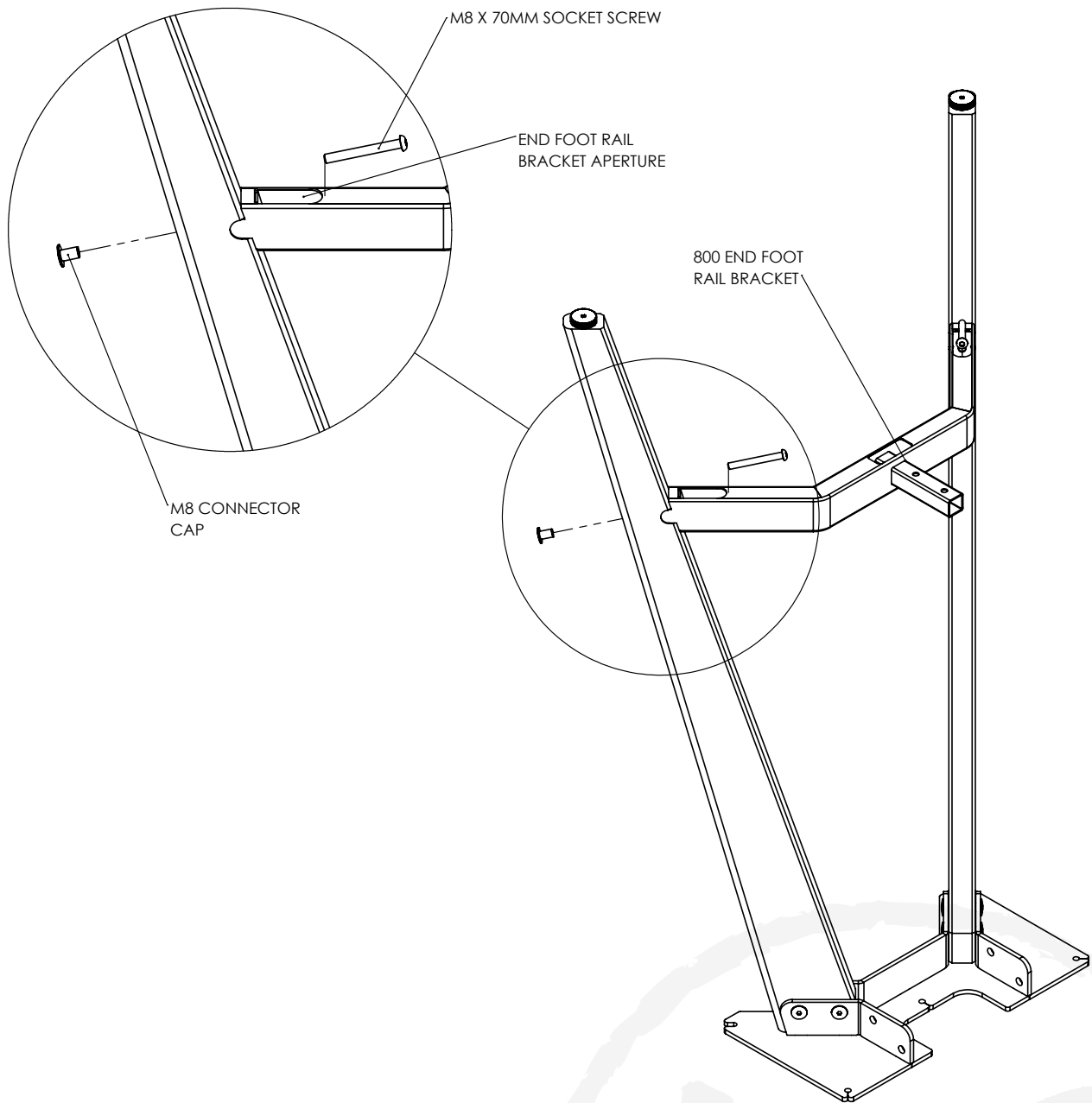

- ASSEMBLE THE LEGS & RAILS ON THE FLOOR LIKE ABOVE
- POSITION THE END FOOT RAIL BRACKET AGAINST THE NOTCHES IN THE LEGS
- PASS AN M8 X 70MM SOCKET SCREW THROUGH THE APERTURE IN THE UNDERSIDE OF THE END FOOT RAIL BRACKET AND PUSH INTO LEG CAVITY.
- PASS THE M8 CONNECTOR CAP INTO THE HOLE IN THE FRONT OF THE LEG AND TIGHTEN TO SECURE

hardware

Fixing kit provided

tool required

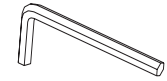
4/5mm
allen key

poseur / one-piece top 800mm deep

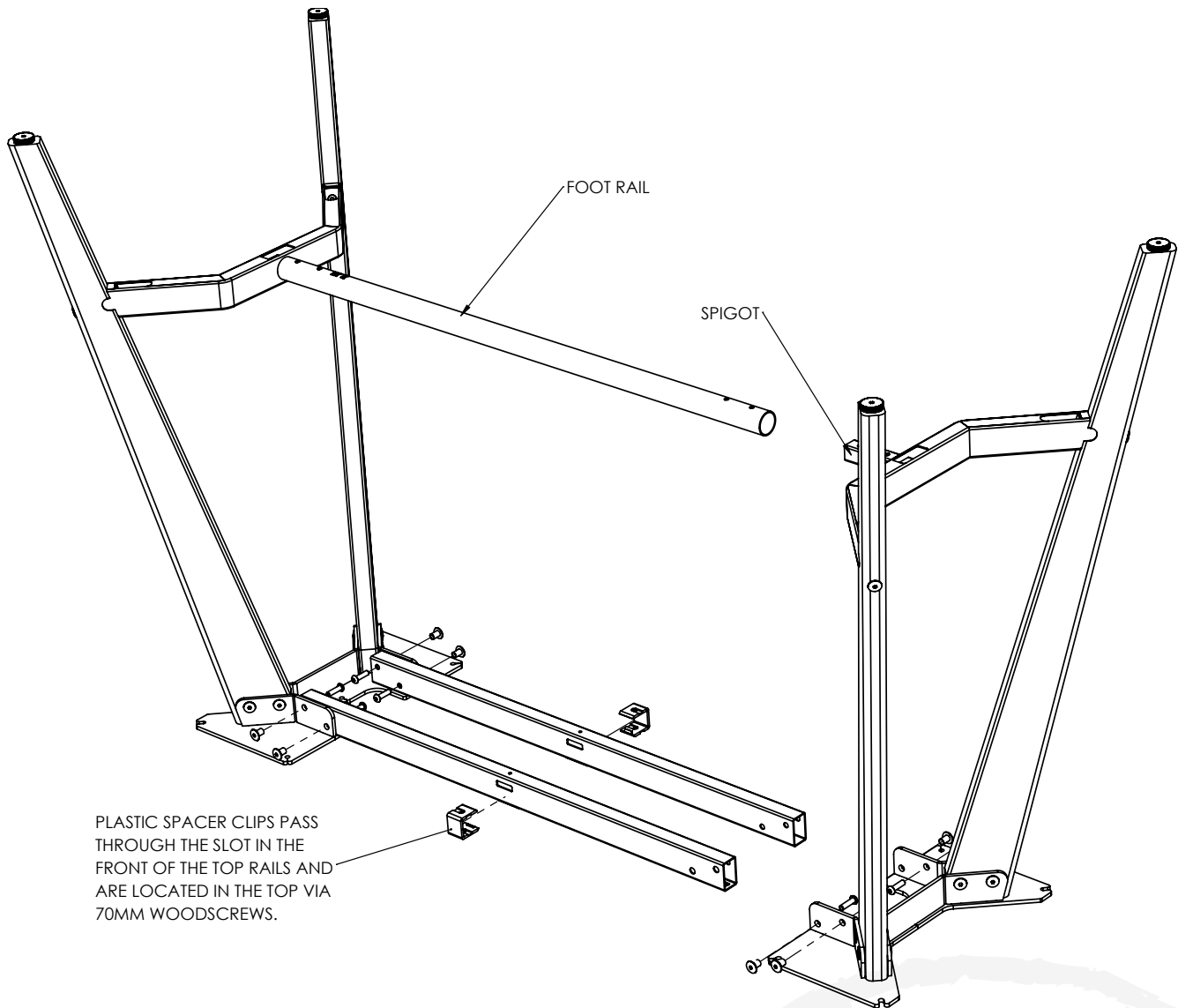

- ASSEMBLE THE PRE-ASSEMBLED END LEG SETS & RAILS ON THE FLOOR LIKE ABOVE. ALIGN THE RAILS AT THE CONNECTION POINTS OF ONE LEG SET
- PASS THE M8 CONNECTOR CAP THROUGH THE FRONT OF THE LEG BRACKET AND RAIL. INSERT THE M8 X 30 SOCKET SCREW INTO THE REAR OF THE RAIL AND TIGHTEN SEQUENTIALLY
- ENSURE THE GRUB SCREWS IN THE SPIGOTS ARE WOUND IN, THEN SLIDE THE FOOT RAILS OVER THE SPIGOT BARS
- UNWIND THE SPIGOT GRUB SCREWS INTO THE FOOT RAILS UNTIL TIGHT
- REPEAT THE STEPS FOR THE OTHER LEGS
- TURN THE FRAME WORK OVER, LOCATE THE TABLE TOP INTO POSITION AND SECURE IN PLACE WITH M6 X 15 CONNECTOR BOLTS THROUGH THE LEG BRACKETS AND 70MM WOODSCREWS THROUGH THE SPACER CLIPS AND RAILS

hardware

Fixing kit provided

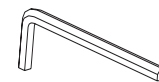
tool required4/5mm
allen key

poseur / one-piece top

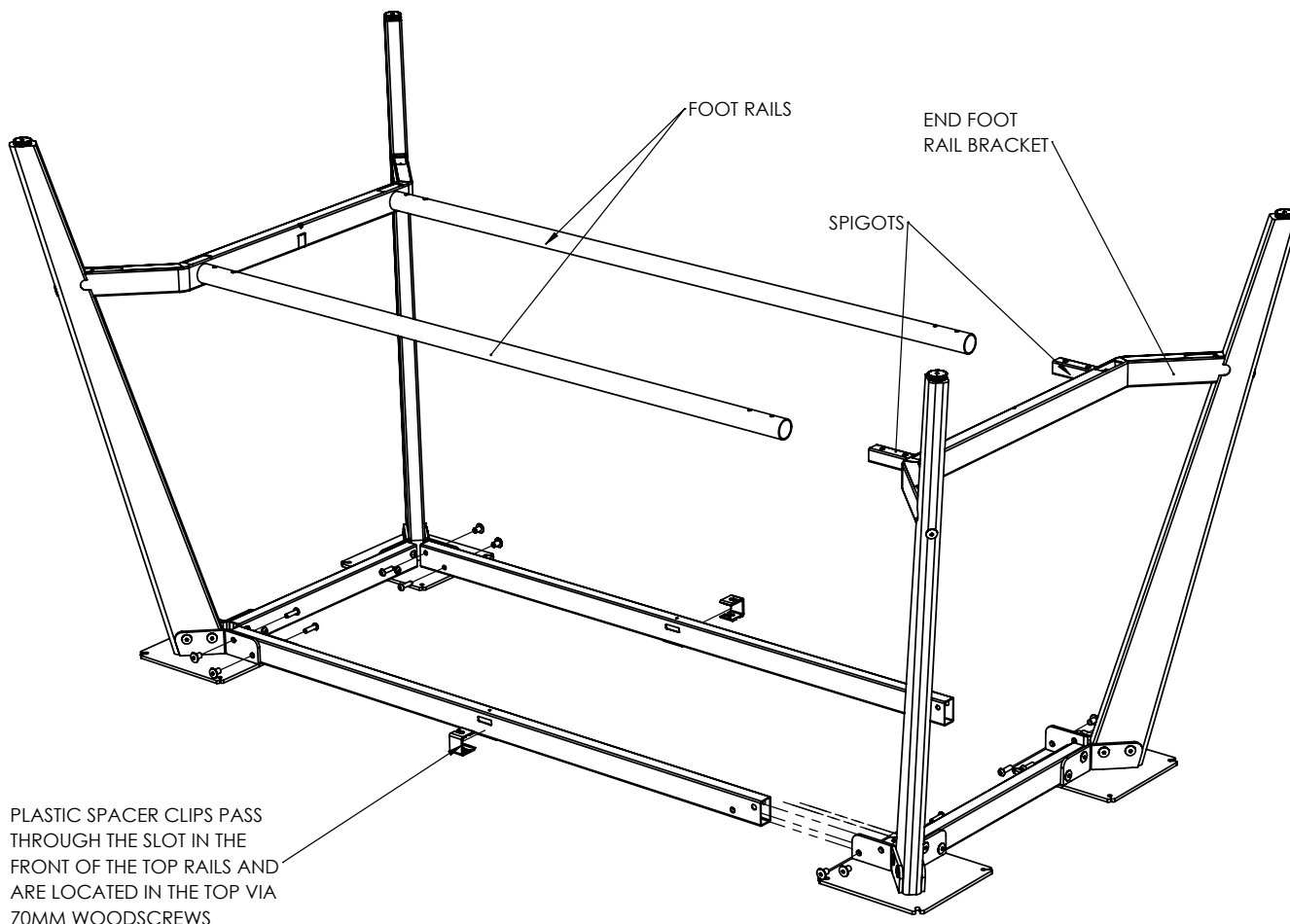

- ASSEMBLE THE PRE-ASSEMBLED LEG SETS & RAILS ON THE FLOOR LIKE ABOVE
- ALIGN THE RAILS AT THE CONNECTION POINTS OF ONE LEG SET
- PASS THE M8 CONNECTOR CAP THROUGH THE FRONT OF THE LEG BRACKET AND RAIL. INSERT THE M8 X 30 SOCKET SCREW INTO THE REAR OF THE RAIL AND TIGHTEN SEQUENTIALLY
- ENSURE THE GRUB SCREWS IN THE SPIGOTS ARE WOUND IN, THEN SLIDE THE FOOT RAILS OVER THE SPIGOT BARS
- UNWIND THE SPIGOT GRUB SCREWS INTO THE FOOT RAILS UNTIL TIGHT
- REPEAT THE STEPS FOR THE OTHER LEG SET
- TURN THE FRAME WORK OVER, LOCATE THE TABLE TOP INTO POSITION AND SECURE IN PLACE WITH M6 X 15 CONNECTOR BOLTS THROUGH THE LEG BRACKETS AND 70MM WOODSCREWS THROUGH THE SPACER CLIPS AND RAILS

hardware

Fixing kit provided

tool required4/5mm
allen key

poseur / multi-top corner leg

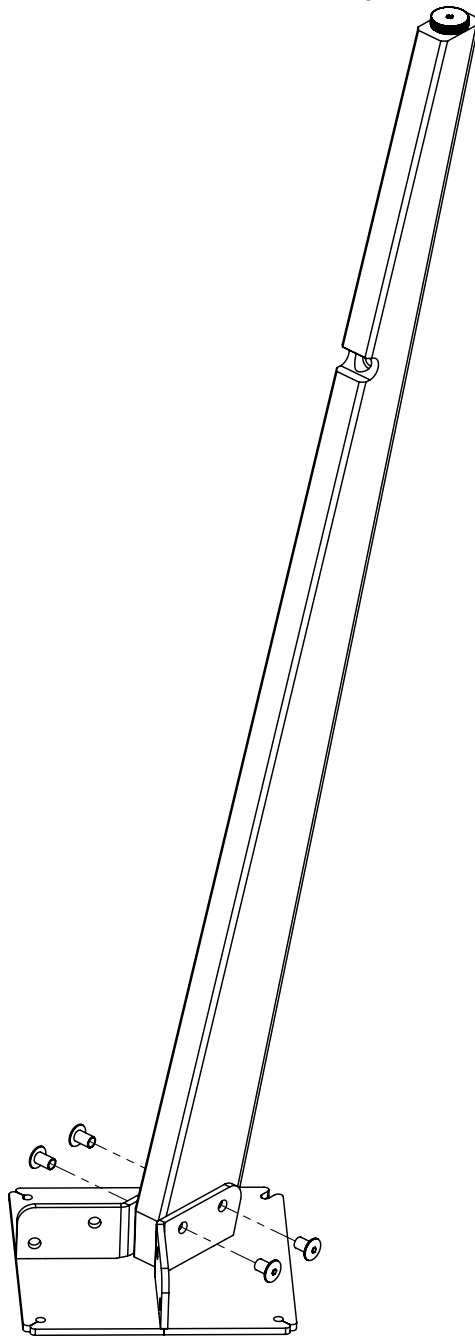
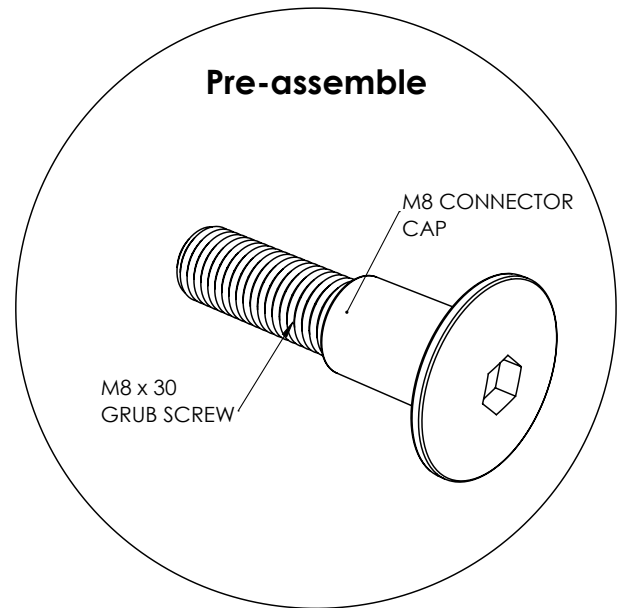
**Pre-assembly**

- PRE-ASSEMBLE THE TWO M8 X 30MM GRUB SCREWS INTO AN M8 CAP SCREW SUPPLIED, AS ABOVE
- PASS THE M8 GRUB SCREW/CAP SCREW ASSEMBLY THROUGH THE CONNECTING BRACKET AND LEG
- SCREW ANOTHER CAP SCREW ONTO THE REAR OF THE GRUB SCREW - LEAVE LOOSE AT THIS STAGE
- REPEAT FOR ALL OTHER BOLTS IN THE ASSEMBLY. WHEN ALL BOLTS ARE IN PLACE, TIGHTEN SEQUENTIALLY TO COMPLETE THE ASSEMBLY

hardware

Fixing kit provided

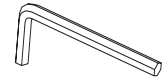
tool required4/5mm
allen key

poseur / multi-top inter leg

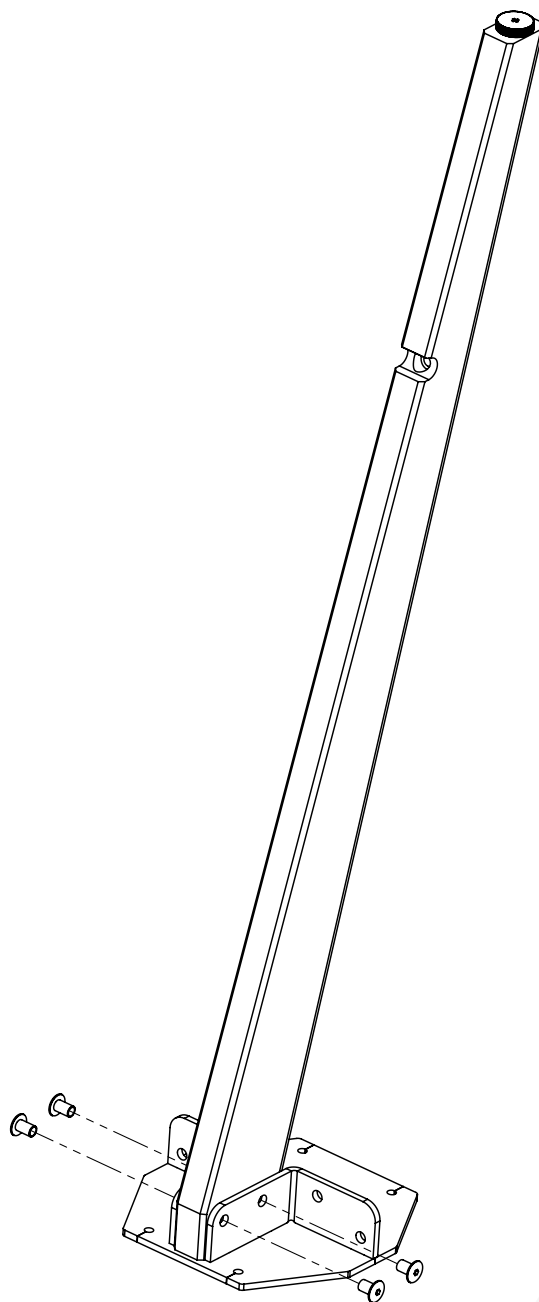
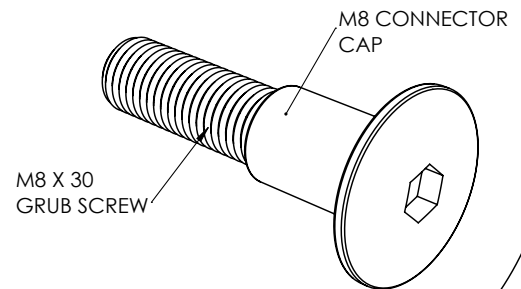
**Pre-assembly**

- PRE-ASSEMBLE THE TWO M8 X 30MM GRUB SCREWS INTO AN M8 CAP SCREW SUPPLIED, AS ABOVE
- PASS THE M8 GRUB SCREW/CAP SCREW ASSEMBLY THROUGH THE CONNECTING BRACKET AND LEG
- SCREW ANOTHER CAP SCREW ONTO THE REAR OF THE GRUB SCREW - LEAVE LOOSE AT THIS STAGE
- REPEAT FOR ALL OTHER BOLTS IN THE ASSEMBLY. WHEN ALL BOLTS ARE IN PLACE, TIGHTEN SEQUENTIALLY TO COMPLETE THE ASSEMBLY

hardware

Fixing kit provided

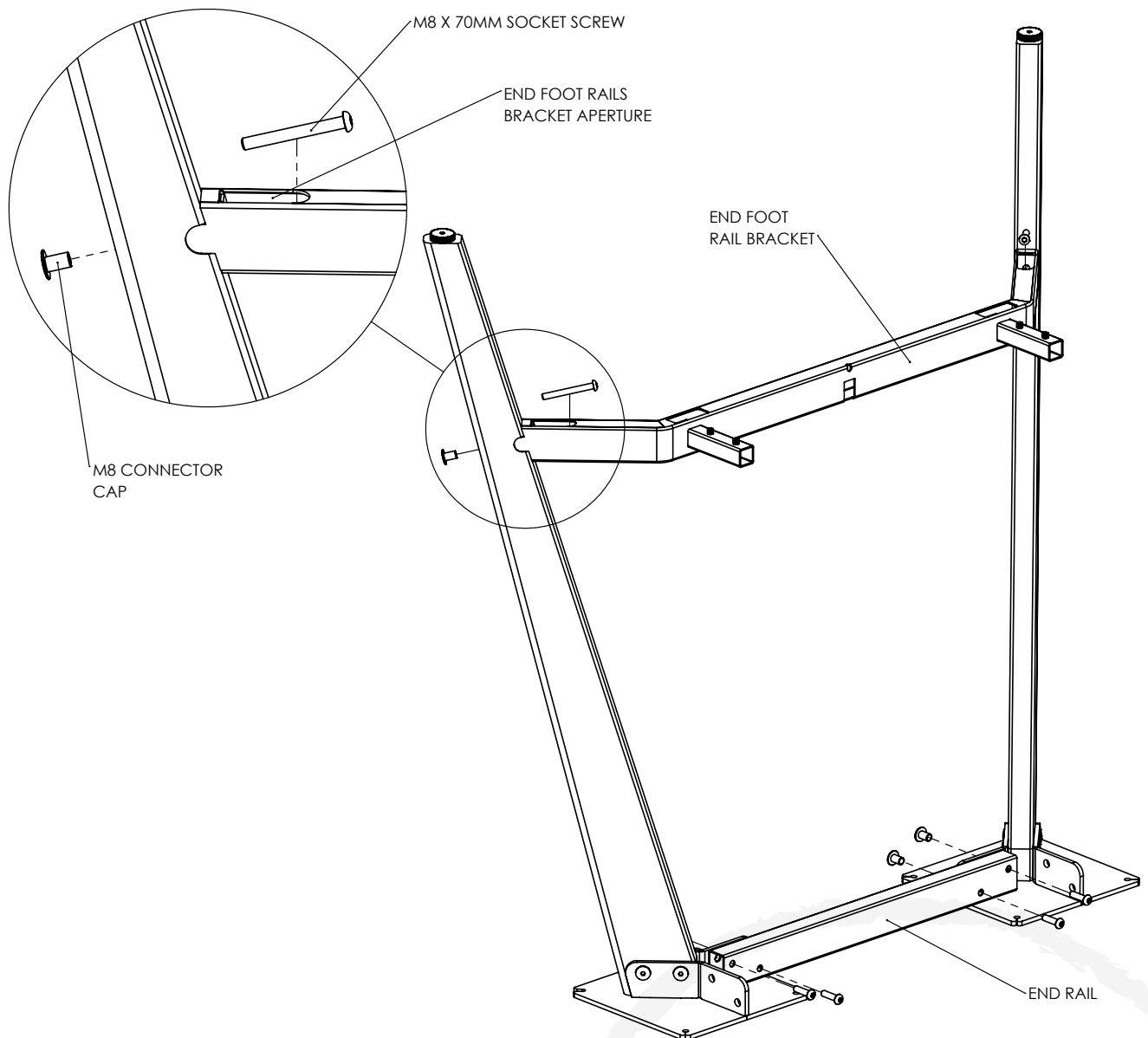
tool required4/5mm
allen key*poseur / multi-top end leg set*

- ASSEMBLE THE LEGS & RAILS ON THE FLOOR LIKE ABOVE
- ALIGN THE END RAIL AT THE CONNECTION POINTS OF THE TWO LEGS
- PASS THE M8 CONNECTOR CAP THROUGH THE FRONT OF THE LEG BRACKET AND RAIL. INSERT THE M8 X 30 SOCKET SCREW INTO THE REAR OF THE RAIL AND TIGHTEN SEQUENTIALLY
- POSITION THE END FOOT RAIL BRACKET AGAINST THE NOTCHES IN THE LEGS
- PASS AN M8 X 70MM SOCKET SCREW THROUGH THE APERTURE IN THE UNDERSIDE OF THE END FOOT RAIL BRACKET AND PUSH INTO LEG CAVITY
- PASS THE M8 CONNECTOR CAP INTO THE HOLE IN THE FRONT OF THE LEG AND TIGHTEN TO SECURE

hardware

Fixing kit provided

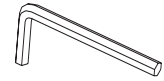
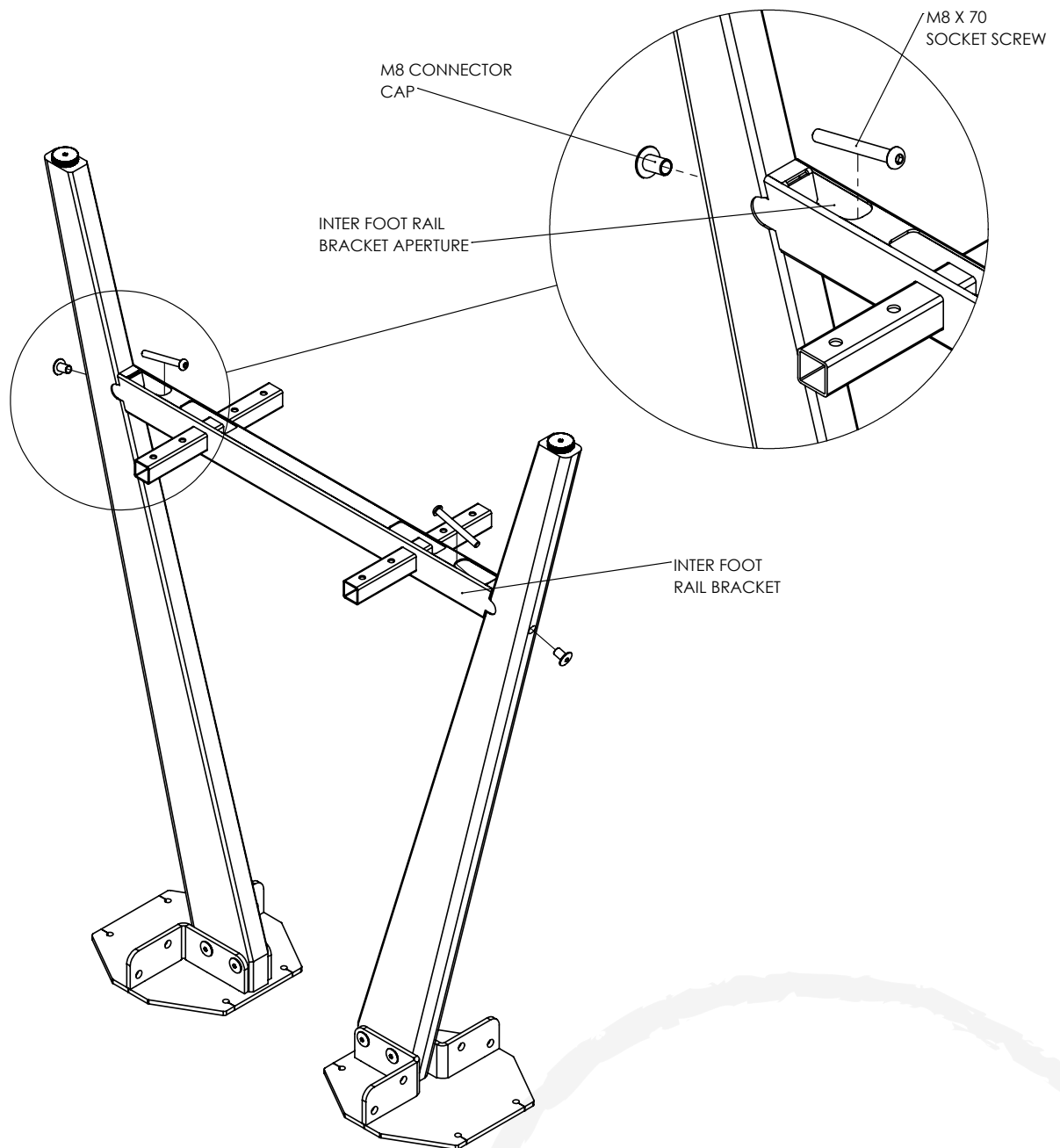
tool required4/5mm
allen key*poseur / multi-top inter leg set*

- ASSEMBLE THE LEGS & RAILS ON THE FLOOR LIKE ABOVE
- POSITION THE INTER FOOT RAIL BRACKET AGAINST THE NOTCHES IN THE LEGS
- PASS AN M8 X 70MM SOCKET SCREW THROUGH THE APERTURE IN THE UNDERSIDE OF THE INTER FOOT RAIL BRACKET AND PUSH INTO LEG CAVITY
- PASS THE M8 CONNECTOR CAP INTO THE HOLE IN THE FRONT OF THE LEG AND TIGHTEN TO SECURE

hardware

Fixing kit provided

tool required

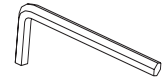

4/5mm
allen key

poseur / multi-top assembly

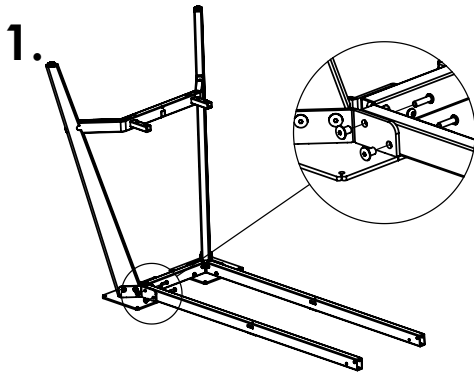

1. Position a pre-assembled end leg set with the end and top rails as above.
2. Align rails at connection points and secure by passing the M8 connector cap through the bracket and rail. Insert the M8 x 30 socket screw into the rear of the rail and tighten.

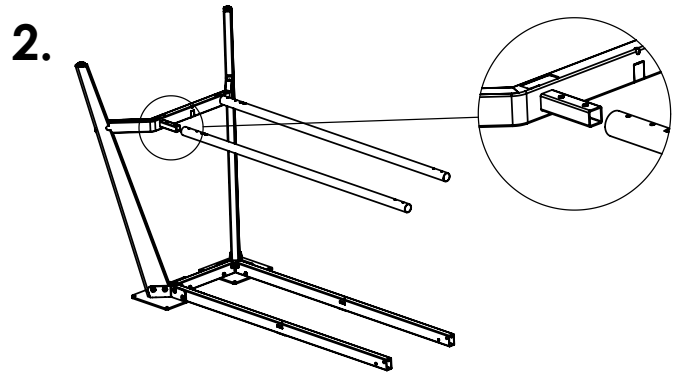

3. Ensure the grub screws in the spigots are wound in, then slide foot rails over the spigots.
4. Unwind the grub screw, into the foot rail to secure.

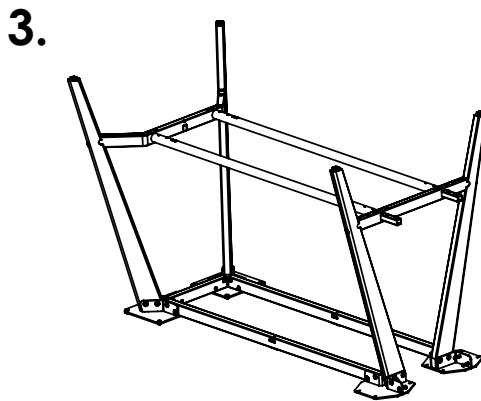

5. Position the inter leg set assembly and slide onto foot rails, unwind grub screw into the foot rail as step 4.
6. Secure connection points between the leg assemblies and rails as step 2.

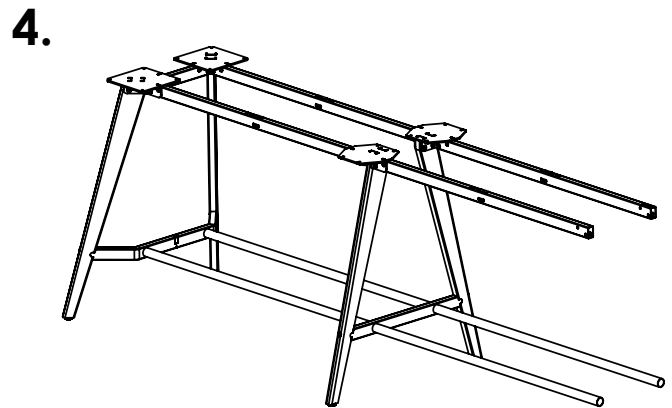

7. Turn the assembly over to the correct orientation and build off this to achieve desired length, repeating previous steps as required.

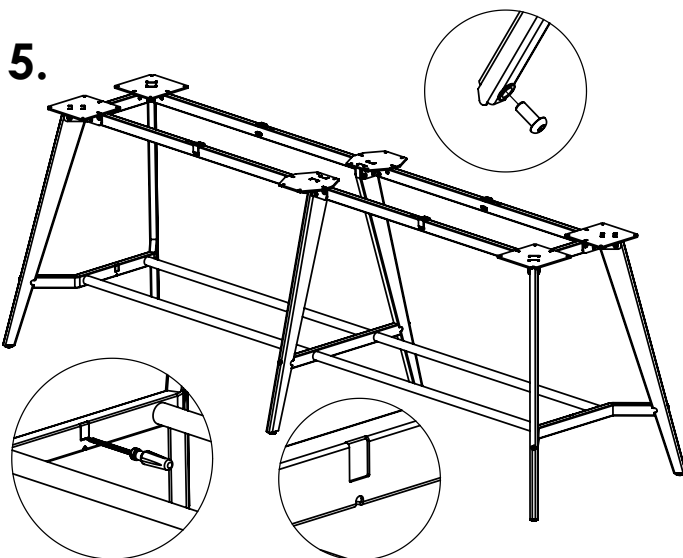

8. Once the final set of rails are attached, attached the final end leg assembly as step 2.
9. If using triangulation rails, breakout the triangulation covers from the end foot rails with a screwdriver.
10. Screw the M8 x 20mm button head bolts into the rivnuts in the triangulation rails. Ensure the bolt is fully screwed in.

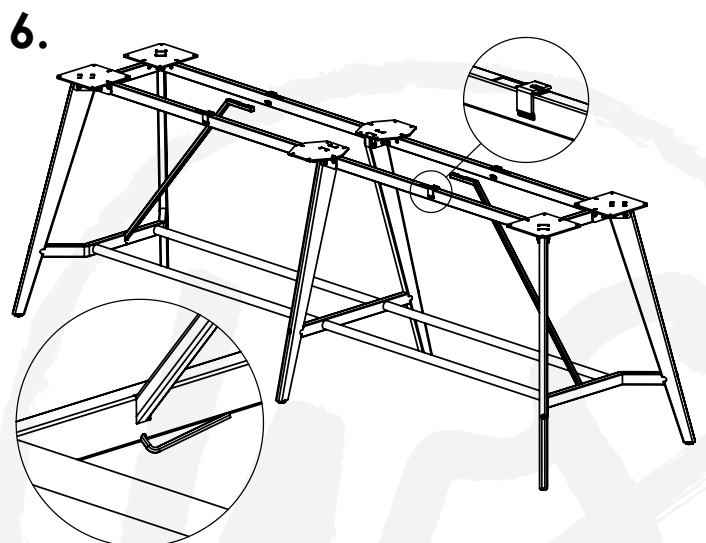

10. Slide the triangulation rails into the end foot rails, ensuring they are fully inserted.
11. Unwind the M8 button head bolt in the triangulation rail to secure.
12. Attach table tops to frame using M6 x 15 connector bolts through the leg brackets and triangulation rails.
13. Slide the spacer clips through the slots in the top rails and secure using 70mm woodscrews.

hardware

Fixing kit provided

tool required

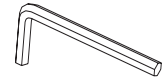
4/5mm
allen key

bench

Fig.1

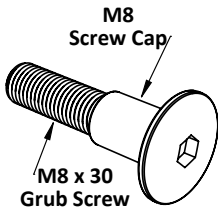

Fig.2

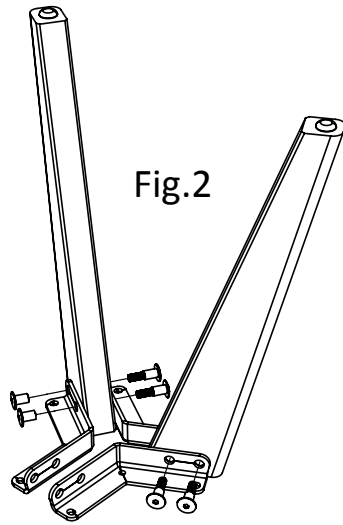

Fig.3

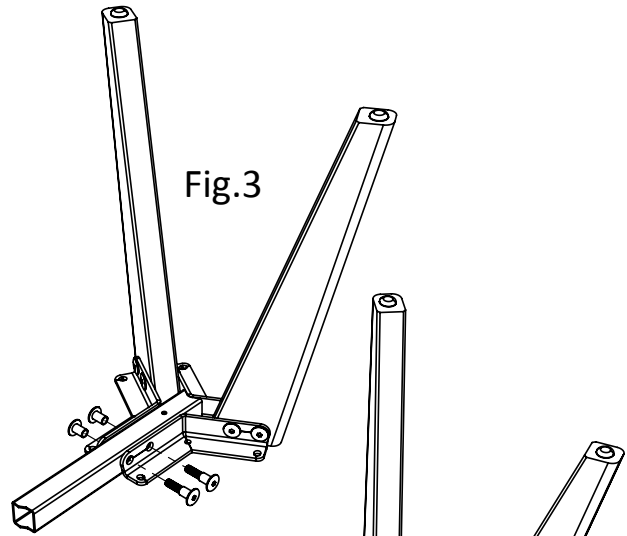
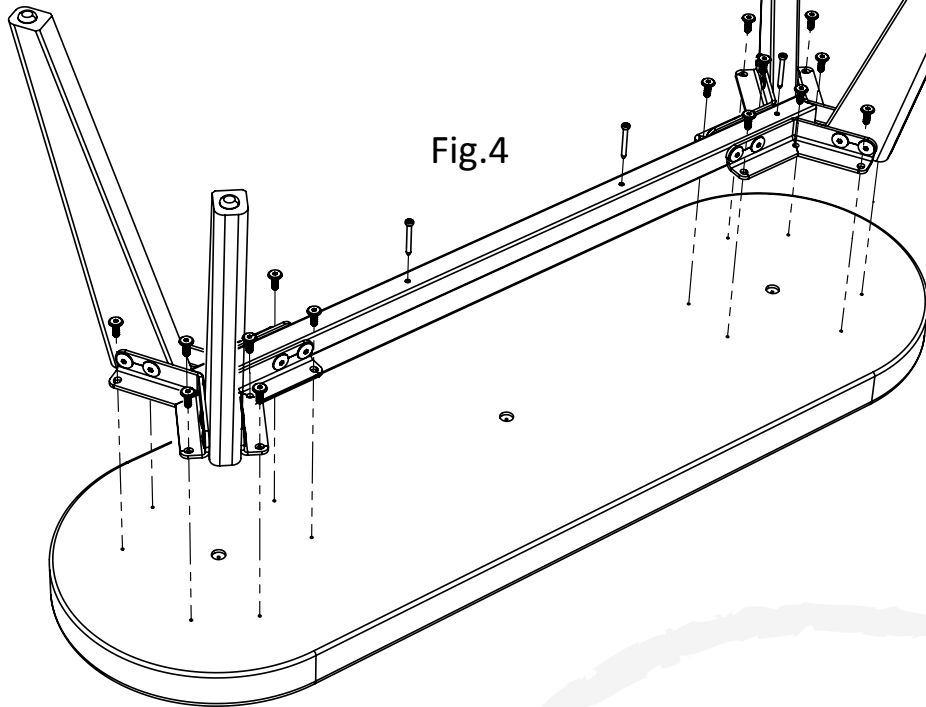
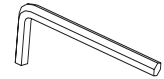

Fig.4



- PRE-ASSEMBLE 12 OF THE M8 GRUB SCREWS INTO 12 OF THE M8 CAP SCREWS SUPPLIED - FIG 1
- ASSEMBLE TWO OF THE LEGS AND THREE BRACKETS, PASS THE M8 GRUB SCREW/CAP SCREW ASSEMBLY THROUGH THE CONNECTING BRACKET AND LEG. SCREW ANOTHER CAP SCREW ONTO THE REAR OF THE GRUB SCREW AND TIGHTEN - FIG 2
- INSERT THE SPINE BETWEEN THE TWO BRACKETS AND FIX IN PLACE USING M8 GRUB SCREWS, CAP FIXINGS AND TIGHTEN - FIG.3 REPEAT THE PROCESS FOR THE OTHER END LEG
- ONCE THE FRAME ASSEMBLY HAS BEEN COMPLETED YOU CAN NOW ALIGN THE FRAME WITH THE PILOT HOLES ON THE SEAT PAD - FIG.4
- FIX THE BRACKETS IN PLACE USING THE BLACK WOOD SCREWS
- TO FIX THE SPINE USE THE 1 3/4" WOOD SCREWS USING A LOW TORQUE SETTING ON THE DRIVER

Fixing kit provided

4/5mm
allen key

high bench

Stage. 1

Pre-assemble 12 of the M8 grub screws into 12 of the M8 cap screws supplied.

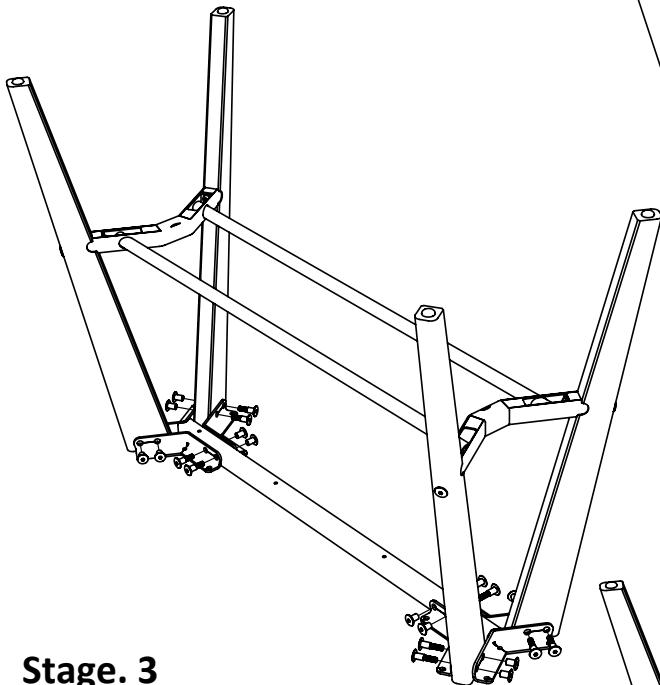
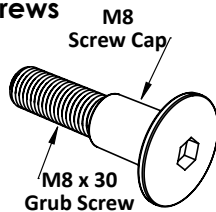

Stage. 3

Assemble the legs and brackets together, pass the M8 grub screw/cap screw assembly through the connecting bracket and leg. Screw another cap screw onto the rear of the grub screw and tighten. Insert the spine between the two brackets and fix in place using M8 grub screws, cap fixings and tighten. You can now securely tighten up the foot rest fixings.

Stage. 2

Connect the legs to the foot rest, pass the M8 x 70 socket screw through the hole in the underside of the foot rest & into the leg take a cap screw and secure the bolt in place. Do not tighten these fully.

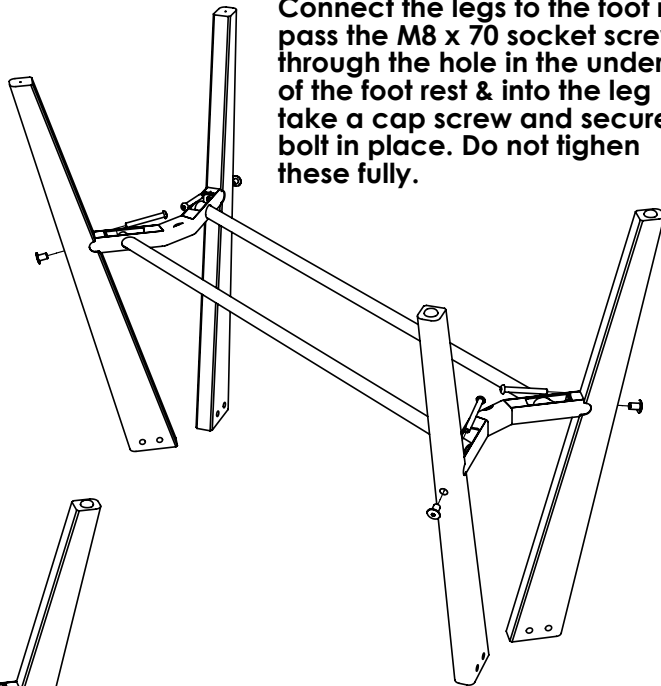

Stage. 4

Once the frame assembly has been completed you can now align the frame with the pilot holes on the seat pad. Fix the brackets in place using the black wood screws. To fix the spine use the 1 3/4" wood screws using a low torque setting on the driver.

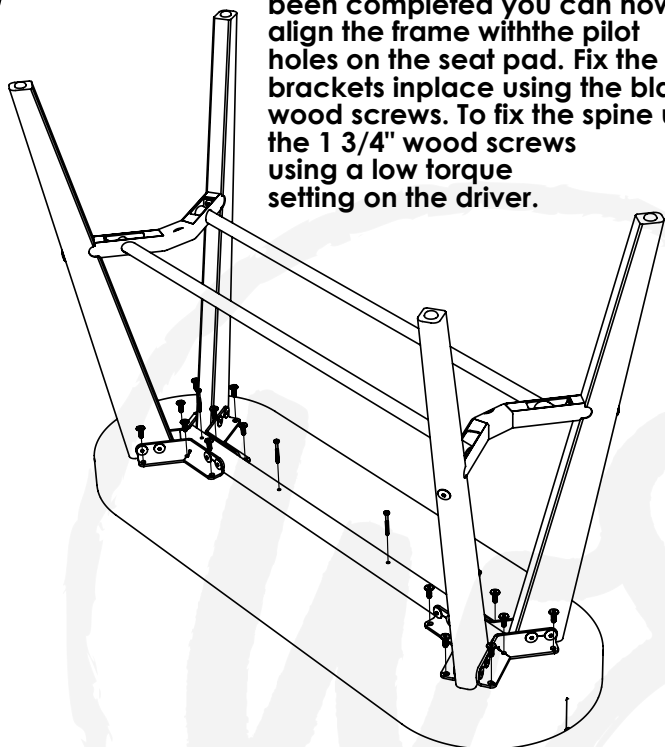



SHOWROOM

13 Northburgh Street,
London EC1V 0JP

CONTACT

Info@workstories.com
+44 (0)20 3735 5224

workstories.com