

**Transfer pumps**

Rotary, self priming, vane pumps featuring high flow rates, and easy operation and installation. The 24/12 version can be used with both voltages.

**Technical features:**

Vane pump with rotor. Incorporated by-pass valve. Connector block with ON/OFF switch. Threaded 1" or 3/4" connectors.



**Carry 3000**  
Flow rate up to **50** l/min

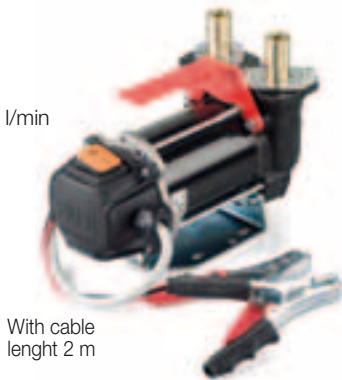

With cable length 2 m

**Carry Panther**  
Flow rate up to **70** l/min



Cable length 2 m

**Kit Carry Bipump**  
(including hose and nozzle)  
Flow rate up to **80** l/min



Delivery hose 6 m  
Cable length 4 m  
Automatic nozzle

**Kit Carry Panther**  
(including hose and nozzle)  
Flow rate up to **70** l/min











Cable length 6 m

Delivery hose 5 m

Automatic or manual nozzle



| Code      | Description              | Pumps   | I/O  | Flow rate |        | DC    | Delivery Hose | Cable length | Nozzle | Weight | Packaging   |
|-----------|--------------------------|---|------|-----------|--------|-------|---------------|--------------|--------|--------|-------------|
|           |                          |   |      | BSP       | l/min  |       |               |              |        |        |             |
| F0022300C | Carry 3000 12V           |  Bypass 2000 | 3/4" | 50        | 13     | 12    | -             | 2            | -      | 4,2    | 215x120x160 |
| F0022400C | Carry 3000 24V / 12V     |  Bypass 2000 | 3/4" | 50 / 30   | 13 / 6 | 24    | -             | 2            | -      | 4,2    | 215x120x160 |
| F0034000B | Carry Panther 12V        |  Panther DC  | 1"   | 56        | 15     | 12    | -             | 2            | -      | 9,1    | 195x355x270 |
| F0034104A | Carry Panther 12/24V     |  Panther DC  | 1"   | 35/70     | 9/18   | 12/24 | -             | 2            | -      | 9,1    | 195x355x270 |
| F0034006B | Kit Carry Panther 12V    |  Panther DC  | 1"   | 56        | 15     | 12    | 5             | 6            | M      | 12,5   | 357x357x275 |
| F00341220 | Kit Carry Panther 12/24V |  Panther DC  | 1"   | 35/70     | 9/18   | 12/24 | 5             | 6            | A      | 13     | 357x357x275 |
| F0034106C | Kit Carry Panther 12/24V |  Panther DC  | 1"   | 35/70     | 9/18   | 12/24 | 5             | 6            | M      | 12,5   | 357x357x275 |
| F00363280 | Kit Carry Bipump 12V     |  Bipump      | 1"   | 80        | 21     | 12    | 6             | 4            | A      | 18     | 360x360x300 |

## II Pompe per travaso.

Di tipo rotativo a palette, autoadescenti, caratterizzate da elevata portata e facilità di funzionamento ed installazione. La versione 24/12 può essere utilizzata con entrambe le tensioni.

### Caratteristiche tecniche:

Pompa a palette con rotore. Valvola by-pass incorporata. Scatola di derivazione con interruttore on/off. Attacchi filettati da 1" o 3/4".

## III Pompes pour transvasement

De type rotatives à palettes, à amorçage automatique, caractérisées par un débit élevé, facile à installer et à utiliser. La version 24/12 peut être utilisée avec les deux tensions.

### Caractéristiques techniques:

Pompe à palettes avec rotor. Soupape by-pass incorporée. Boîte de dérivation avec interrupteur on/off. Raccords filetés de 1" o 3/4".

## DE Umfüllpumpen

Selbstanfüllende Flügelzellenpumpen, gekennzeichnet durch hohe Förderleistung und einfache Betriebsweise und Installation. Die Version 24/12 lässt sich mit beiden Spannungen verwenden.

### Technische Merkmale:

Flügelzellenpumpe mit Rotor. Eingebautes Bypass-Ventil. Abzweigdose mit Ein-/Ausschalter. Gewindeanschlüsse 1" oder 3/4".

## EB Bombas de trasiego

Bombas de tipo rotativo de paletas, autocebantes, caracterizadas por su elevado caudal, así como por su fácil funcionamiento e instalación. La versión 24/12 puede ser utilizada con ambas tensiones.

### Características técnicas:

Bomba de paletas con rotor. Válvula de by-pass incorporada. Caja de derivación con interruptor de encendido/apagado. Conexiones embridadas de 1" y 3/4".

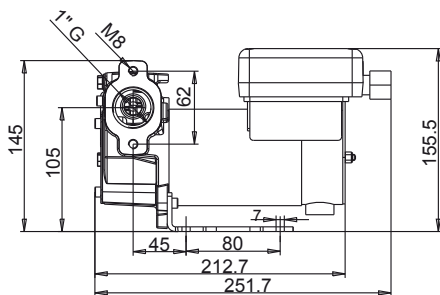

Carry Panther

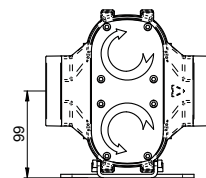
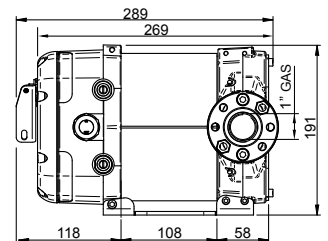
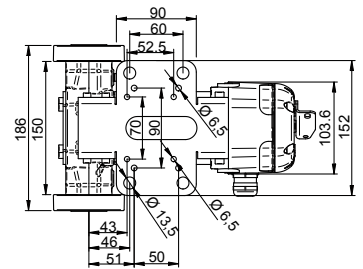
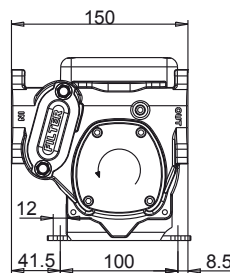

Carry Bipump

**LUBE Control**  
Lube Control Pty Ltd  
Providing lubrication solutions!  
Unit 5/53 Norfolk Rd,  
Marion, SA 5043  
t: (08) 8298 5563  
f: (08) 8298 6253  
e: info@lubecontrol.com.au  
www.lubecontrol.com.au

The Company reserves the right to modify the information contained in this catalogue without any prior notice



Certified  
ISO 9001 / ISO 14001

**PIUSI S.p.A.**  
46029 Suzzara (Mantova) ITALY  
Tel. +39-0376.534561  
Fax: +39-0376.536393  
e-mail: piusi@piusi.com  
www.piusi.com

**PIUSI USA, Inc.**  
5553 Anglers Ave Suite 104  
Fort Lauderdale FL33312  
Tel. : 954 584 1552  
Fax.: 954 584 1554  
Email: piusiusa@piusiusa.com  
www.piusiusa.com