

Supreme Duty Hose Reels

T SERIES

AVAILABLE IN: **SPRING DRIVEN**
EZ-COIL®

NEW FOR 2008

COXREELS® T Series "Truck Mount" spring driven hose reels are the toughest hose reels in the spring driven line. The extra large chassis is strongly supported by dual pedestal-style arms that span from the roller guide bracket down to the sturdy mounting base. Triple support points to the center shaft are complimented by Coxreels' original Super Hub™ support system. They're perfect for off-road applications that demand reliability in the most abusive and demanding environments.

LOW PRESSURE Models with hose are for air or water service with a maximum temperature 150° F. Models less hose can be used for air, water or oil. **NOTE: Do not exceed listed hose O.D. to obtain maximum length.**

HOSE						LESS HOSE		SIZE INDEX
MODEL	I.D.	O.D.	FT.	PSI	APRX. LBS.	MODEL	APRX. LBS.	
TSH-N-350	3/8"	2 1/32"	50	300	61	TSHL-N-350	55	1
TSH-N-375	3/8"	2 1/32"	75	300	82	TSHL-N-375	73	3
TSH-N-3100	3/8"	2 1/32"	100	300	85	TSHL-N-3100	74	3
TSH-N-3125	3/8"	2 1/32"	125	300	103	TSHL-N-3125	90	3
TSH-N-450	1/2"	2 7/32"	50	300	63	TSHL-N-450	55	2
TSH-N-475	1/2"	2 7/32"	75	300	82	TSHL-N-475	71	3
TSH-N-4100	1/2"	2 7/32"	100	300	95	TSHL-N-4100	80	3
TSH-N-535	3/4"	1 9/32"	35	300	77	TSHL-N-535	67	5
TSH-N-550	3/4"	1 9/32"	50	300	83	TSHL-N-550	70	5
TSHF-N-550*	3/4"	1 9/32"	50	300	91	TSHL-N-550	70	5
TSH-N-575	3/4"	1 9/32"	75	300	93	TSHL-N-575	73	8
TSHF-N-575*	3/4"	1 9/32"	75	300	105	TSHL-N-575	73	8
TSH-N-635	1"	1 7/16"	35	300	92	TSHL-N-635	71	6
TSHF-N-635*	1"	1 7/16"	35	300	95	TSHL-N-635	71	6
TSH-N-650	1"	1 7/16"	50	300	98	TSHL-N-650	77	8
TSHF-N-650*	1"	1 7/16"	50	300	101	TSHL-N-650*	77	8

*These models are supplied with fuel hose

MEDIUM PRESSURE Reels are furnished with standard one wire braid hose suitable for air, water or oil applications. Hose exceeds SAE R1 specifications. Maximum temperature 250° F. **NOTE: Do not exceed listed hose O.D. to obtain maximum length.**

HOSE						LESS HOSE		SIZE INDEX
MODEL	I.D.	O.D.	FT.	PSI	APRX. LBS.	MODEL	APRX. LBS.	
TMP-N-350	3/8"	5/8"	50	3000	74	TMPL-N-350	61	2
TDMP-N-350**	3/8"	5/8"	50	3000	104	TDMP-L-350	79	7
TMP-N-375	3/8"	5/8"	75	3000	99	TMPL-N-375	80	3
TMP-N-3100	3/8"	2 1/32"	100	3000	106	TMPL-N-3100	82	3
TMP-N-450	1/2"	3/4"	50	2500	77	TMPL-N-450	64	2
TDMP-N-450**	1/2"	3/4"	50	2500	106	TDMP-L-450	78	7
TMP-N-475	1/2"	3/4"	75	2500	100	TMPL-N-475	80	3
TMP-N-4100	1/2"	3/4"	100	2500	106	TMPL-N-4100	80	3
TMP-N-525	3/4"	1"	25	1500	67	TMPL-N-525	57	4
TMP-N-535	3/4"	1"	35	1500	88	TMPL-N-535	74	5
TMP-N-550	3/4"	1"	50	1500	94	TMPL-N-550	74	5
TMP-N-575	3/4"	1"	75	1500	100	TMPL-N-575	77	8
TMP-N-650	1"	1 7/16"	50	1250	116	TMPL-N-650	81	8

**These models are designed for dual-hydraulic hose applications. See page 24

HIGH PRESSURE Reels are furnished standard with S.A.E. 100R16 #1 or #2 wire braid hose suitable for grease and hydraulic oil applications. Maximum temp. 250° F. **NOTE: Do not exceed listed hose O.D. to obtain maximum length.**

HOSE						LESS HOSE		SIZE INDEX
MODEL	I.D.	O.D.	FT.	PSI	APRX. LBS.	MODEL	APRX. LBS.	
THP-N-150	1/4"	1 7/32"	50	5000	74	THPL-N-150	62	2
THP-N-175	1/4"	1 7/32"	75	5000	88	THPL-N-175	71	3
THP-N-1100	1/4"	1 7/32"	100	5000	104	THPL-N-1100	82	3
THP-N-350	3/8"	4 3/64"	50	4000	78	THPL-N-350	66	4
THP-N-375	3/8"	4 3/64"	75	4000	98	THPL-N-375	80	5

REEL DIMENSIONS Technical Data Sheets Available On Website

SIZE INDEX	A	B	C	D	E	MOUNT L-M
1	83 1/4"	21 3/16"	19 5/8"	8"	9"	7" - 8"
2	91 1/4"	21 3/16"	19 5/8"	8"	9"	7" - 8"
3	91 1/4"	25 1/2"	23"	8"	9"	7" - 8"
4	93 1/4"	21 3/16"	19 5/8"	8"	9"	7" - 8"
5	93 1/4"	25 1/2"	23"	8"	9"	7" - 8"
6	10"	25 1/2"	23"	8"	9"	7" - 8"
7	10 3/4"	25 1/2"	23"	8"	9"	7" - 8"
8	12 1/2"	25 1/2"	24"	8"	9"	7" - 8"

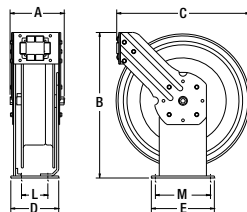

YOUR TRUCK REALLY WANTS THIS ONE!

Three Support Points To The Center Shaft With Super Hub™

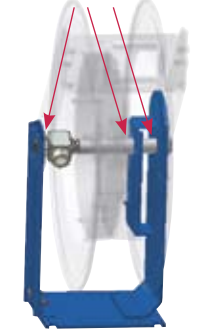

T SERIES Offers...

This year we are offering 6 NEW T-Series models that feature 75' hose of 3/4" & 50' hose of 1"

Also NEW for this year all T-Series reels with 3/4" or 1" hose come with Stainless Steel Rollers FREE of charge! All other T-Series reels upgraded with "BXH" option will come with Stainless Steel Rollers

Hose I.D.: 1/4" - 1" Pressure: To 5,000 PSI

- ✓ Dual Pedestal-Style Support Arms & Base
- ✓ Triple Axle Support Points To The Center Shaft With Coxreels' Original Super Hub™ Axle Support System
- ✓ Built For Rugged Mobile Applications
- ✓ Swivel Seals: NITRILE

SPRING DRIVEN FEATURES:

- ✓ Auto Rewind Easily Wraps, Stores & Protects Hose
- ✓ Heavy Gauge Steel Base & Support Post
- ✓ Factory-Matched Cartridge-Style Spring Motor
- ✓ Solid Machined Brass Swivel (Zinc Plated Steel On HP Models)
- ✓ 1" Solid Steel Axle With 1" Lubricated Precision Bearings
- ✓ Guide Arm Adjusts To Wall, Floor & Overhead Positions
- ✓ Multi-Position Lock Ratchet Secures Hose At Desired Length
- ✓ Non-Corrosive Stainless Steel Spring, Pawl & Zinc Plated Ratchet

COXREELS® SIGNATURE FEATURES:

- ✓ Professional Grade Heavy Duty Steel Construction
- ✓ Durable Proprietary CPC™ Powder Coat Process
- ✓ Rolled Edges & Ribbed Discs Provide Strength & Safety
- ✓ Leading 2-Year Manufacturer's Limited Warranty
- ✓ Made In The U.S.A. Sold & Supported Worldwide

HOW TO ORDER?
See Page 5 For Details

NEED SPECIAL O-RINGS
See Page 35 For Details

AVAILABLE OPTIONS

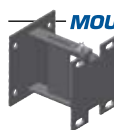

MOUNTING BRACKETS
ENHANCE PERFORMANCE
EASIER INSTALLATION
WALL, FLOOR & CEILING
MANY STYLES AVAILABLE
See Page 34 For Selection

UPGRADE TO EZ-COIL®

INCREASE OPERATOR SAFETY
AVOID PERSONAL INJURY
LONGER REEL LIFE
See Page 3 For More Details

HOSE UPGRADE

PROTECTION FROM THE ELEMENTS
EXTENDED HOSE LIFE
APPLICATION SPECIFIC
See Page 33 For More Details



STAINLESS STEEL
SWIVELS, PLUMBING
& CONSTRUCTION
FOR NON-CORROSIVE
PURE PRODUCT FLOW
See Page 15 For Details



Toll Free 800-COX-REEL • Fax 800-229-REEL • Int 480-820-6396 • Fax 480-820-5132 • www.coxreels.com

